

GEM P INSTALLATION INSTRUCTIONS



WARNING - RISK OF FIRE AND ELECTRICAL SHOCK. FIXTURE MUST BE INSTALLED BY A QUALIFIED ELECTRICIAN ONLY. FIXTURE IS INTENDED FOR INSTALLATION IN ACCORDANCE WITH THE NATIONAL ELECTRICAL CODE, LOCAL AND FEDERAL SPECIFICATIONS. DISCONNECT POWER AT ELECTRICAL PANEL BEFORE SERVICING. RETAIN THESE INSTRUCTIONS FOR MAINTENANCE REFERENCE.

FIXTURE INSTALLATION – NO J-BOX

LOW VOLTAGE / LINE VOLTAGE

1

CUT-OUT TABLE	
FIXTURE	CUTOUT
GEM 2 P	61mm/ 2.34"
GEM L 2 P	61mm/ 2.34"
GEM L 4 P	61mm/ 2.34"

2

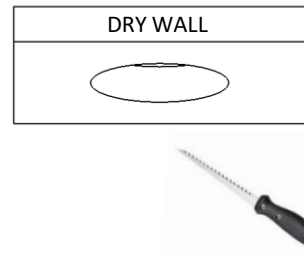

3

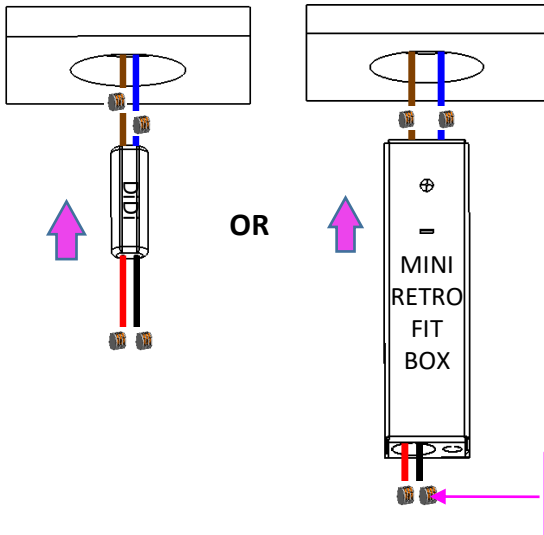

4

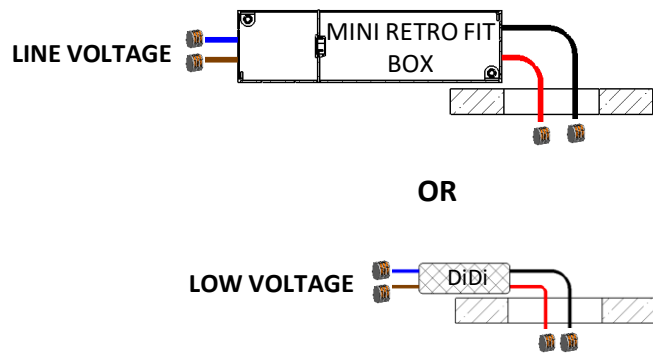

NOTE:

- USE DIDI DRIVER FOR LOW VOLTAGE
- USE MINI RETROFIT BOX FOR LINE VOLTAGE

1. CUT A HOLE PER THE CEILING CUTOUT TABLE. (FIGURE 1 & 2)
2. PULL LOW / LINE VOLTAGE WIRES THROUGH THE CUT-OUT.
3. CONNECT LOW VOLTAGE WIRES TO THE DiDi DRIVER OR LINE VOLTAGE TO THE MINI RETROFIT BOX USING PROVIDED WAGO CONNECTORS. CONNECT NEUTRAL TO BLUE/WHITE AND HOT TO BROWN/BLACK. (FIGURE 3)
4. PUSH THE DiDi DRIVER OR MINI RETROFIT BOX INSIDE THE CEILING PLENUM. THEY WILL SIT ON TOP OF THE CEILING. (FIGURE 3 & 4)

FIXTURE INSTALLATION – NO J-BOX

LOW VOLTAGE / LINE VOLTAGE

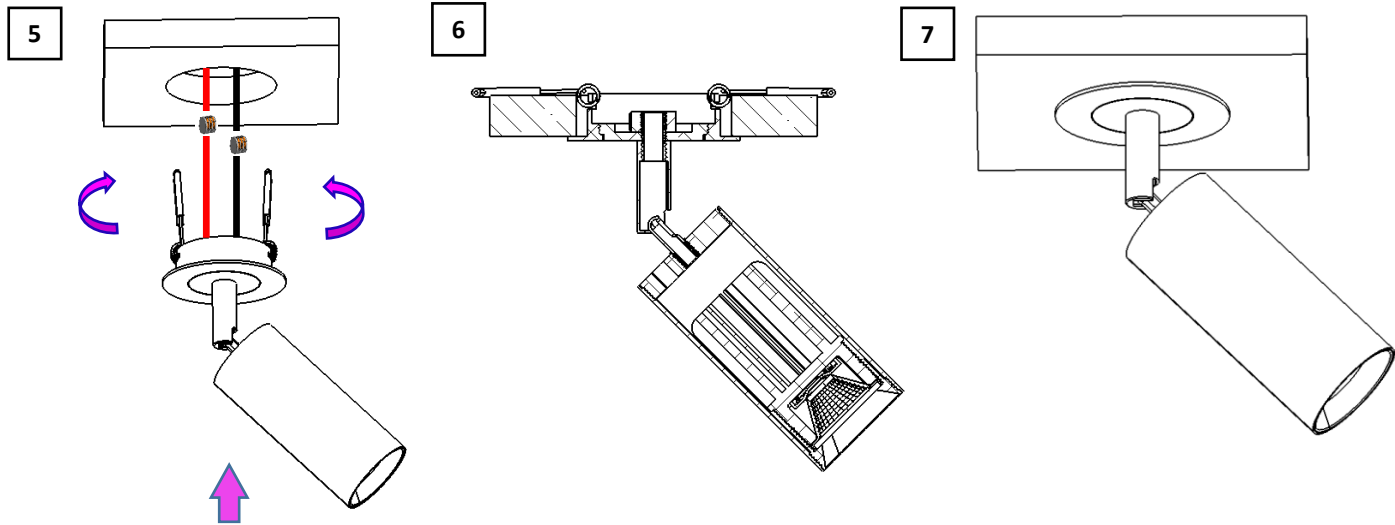

5. CONNECT THE OUTPUT FROM THE DRIVER TO THE GEM FIXTURE USING THE WAGO CONNECTOR. CONNECT RED TO RED AND BLACK TO BLACK. (FIGURE 5)
6. OPEN SPRINGS AND INSERT THE FIXTURE INTO THE CUT-OUT OPENING. MAKE SURE ALL THE WIRES ARE ALL THE WAY IN THE CEILING. (FIGURE 5 & 6)
7. IF THE FIXTURE IS ORIENTABLE, ORIENT THE FIXTURE. PROCEED TO SWITCH POWER ON. (FIGURE 7)

FIXTURE INSTALLATION – REGRESSED J-BOX LINE VOLTAGE

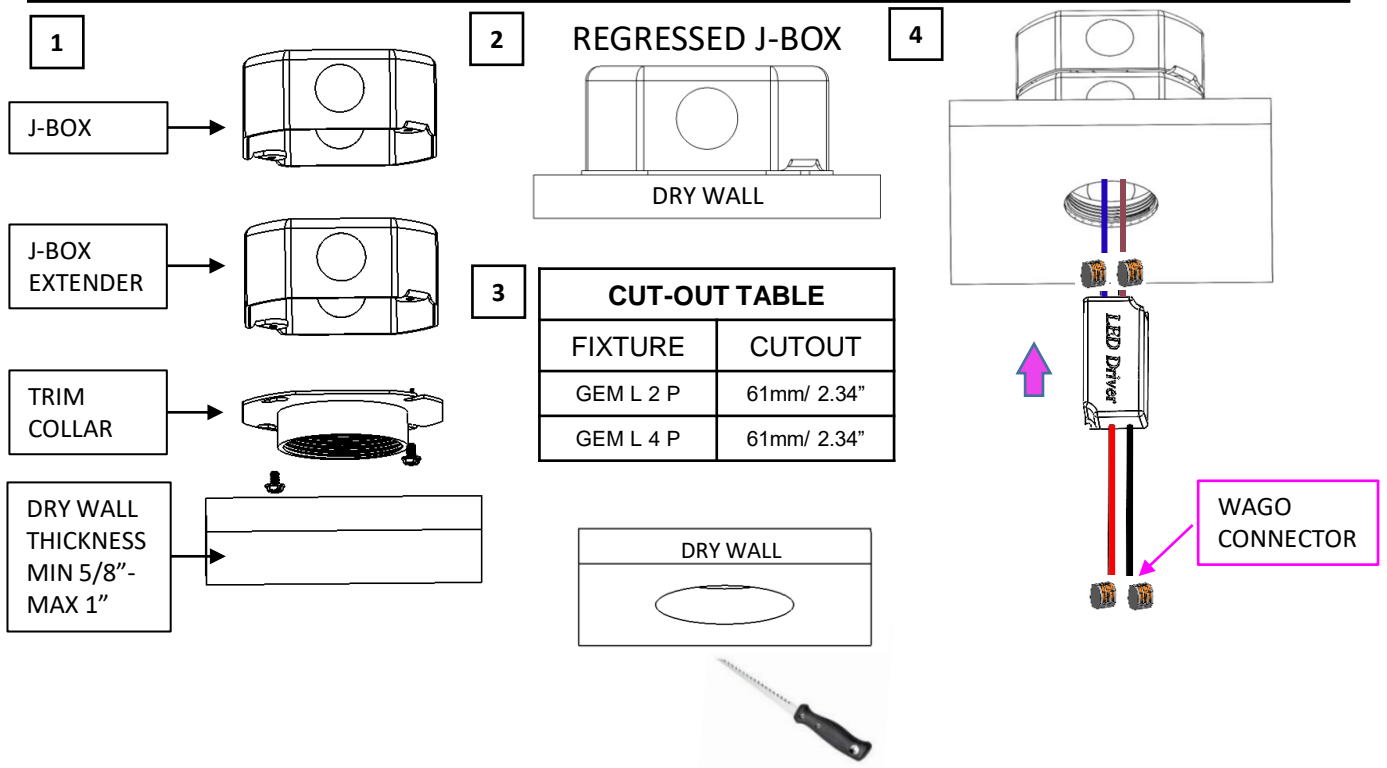

1. MAKE SURE A J-BOX EXTENDER IS USED. THE TOTAL DEPTH OF THE J-BOX SHOULD BE 3" OR MORE. (FIGURE 1)
2. SCREW THE TRIM COLLAR TO THE J-BOX USING TWO SCREWS (NOT SUPPLIED BY ZANIBONI LIGHTING). THE TRIM COLLAR ACCOMMODATES FOR 5/8" TO 1" DRYWALL THICKNESS.(FIGURE 1)
3. INSTALL J-BOX ABOVE CEILING LINE (FIGURE 2)
4. CLOSE CEILING LEAVING A CUT-OUT IN THE DRYWALL AS PER THE CUTOUT TABLE. (FIGURE 3)
5. CONNECT DRIVER TO LINE VOLTAGE USING PROVIDED WAGO CONNECTORS. CONNECT NEUTRAL TO BLUE/WHITE AND HOT TO BROWN/BLACK. (FIGURE 4)

FIXTURE INSTALLATION – REGRESSED J-BOX LINE VOLTAGE

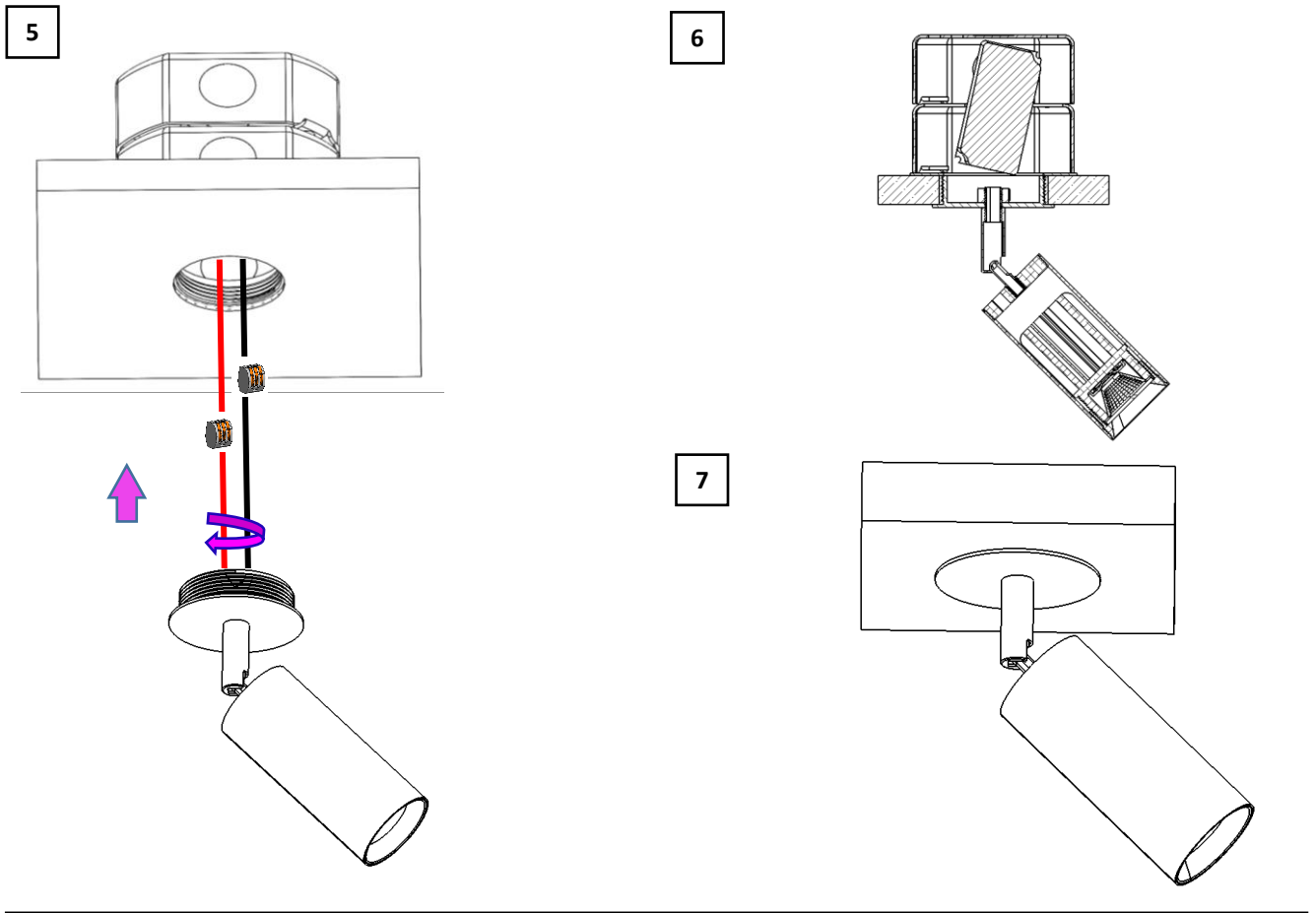

6. CONNECT THE DRIVER TO THE GEM FIXTURE USING THE WAGO CONNECTOR. CONNECT RED TO RED AND BLACK TO BLACK. (FIGURE 5)
7. INSERT THE DRIVER IN J-BOX. ZANIBONI DRIVER WILL SIT INSIDE THE J-BOX. MAKE SURE THE WAGO CONNECTORS ARE ACCOMODATED INSIDE THE J-BOX (FIGURE 6)
8. SCREW THE FIXTURE INTO THE TRIM COLLAR OPENING. MAKE SURE ALL THE WIRES ARE ALL THE WAY IN THE J-BOX.(FIGURE 5)
9. IF THE FIXTURE IS ORIENTABLE, ORIENT THE FIXTURE. PROCEED TO SWITCH POWER ON. (FIGURE 7)